

Architectural cross-section drawing of a roof structure, labeled "ŘEZ A-A". The drawing shows a gabled roof with a central vertical axis. The roof is supported by a central vertical post and two side posts. The roof pitch is indicated by a vertical line on the left side, labeled "0,605". The roof structure is shown in a simplified line-drawing style, with the roof and supporting posts clearly defined. The drawing is oriented horizontally, with the roof slope facing upwards.

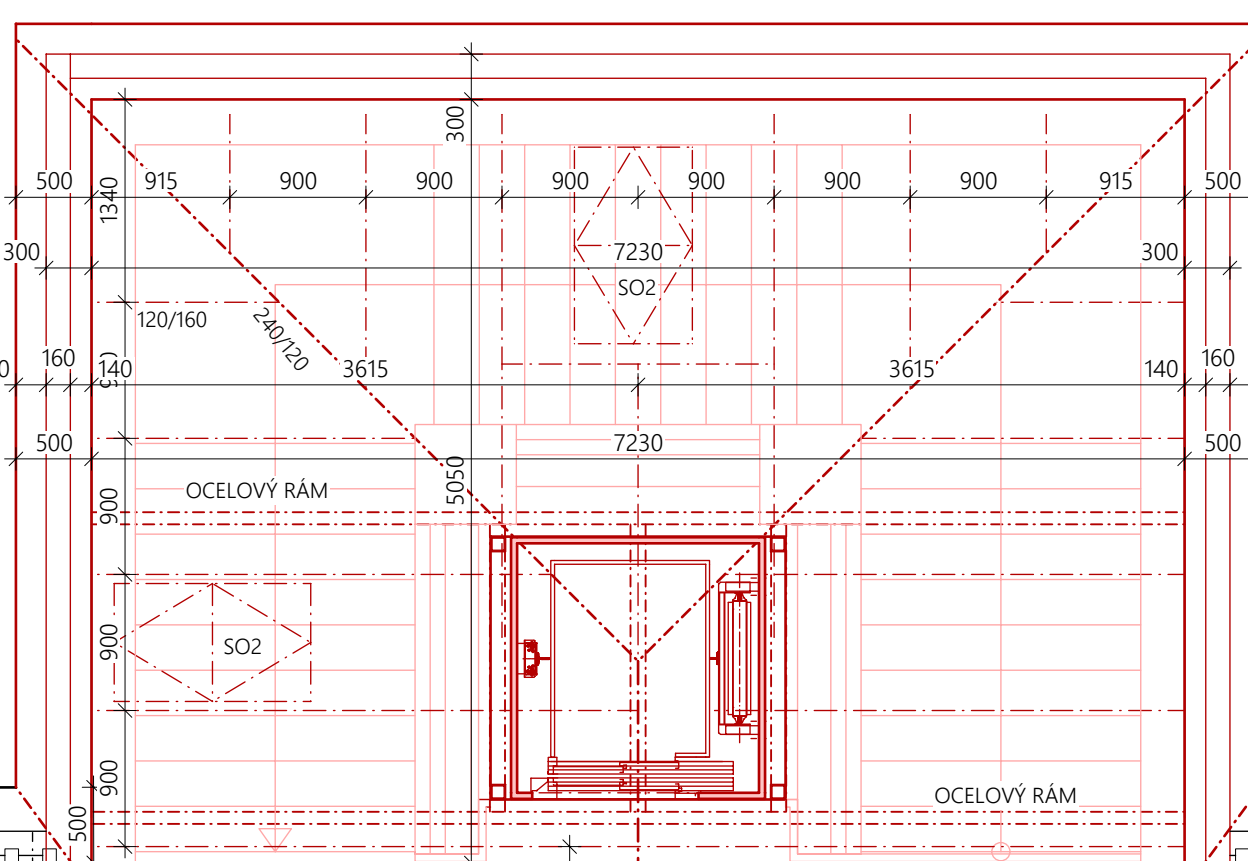

OCELOVÝ RÁM JE POD ÚROVNÍ KROKVI, V SÁDROKARTONOVÉM PODHLEDU
 - SLOUŽÍ PRO UKOTVENÍ VÝTAHOVÉ ŠACHTY A PODEPŘENÍ
 VRCHOLKOVÉ VAZNICE SCHODIŠŤOVÉHO PROSTORU

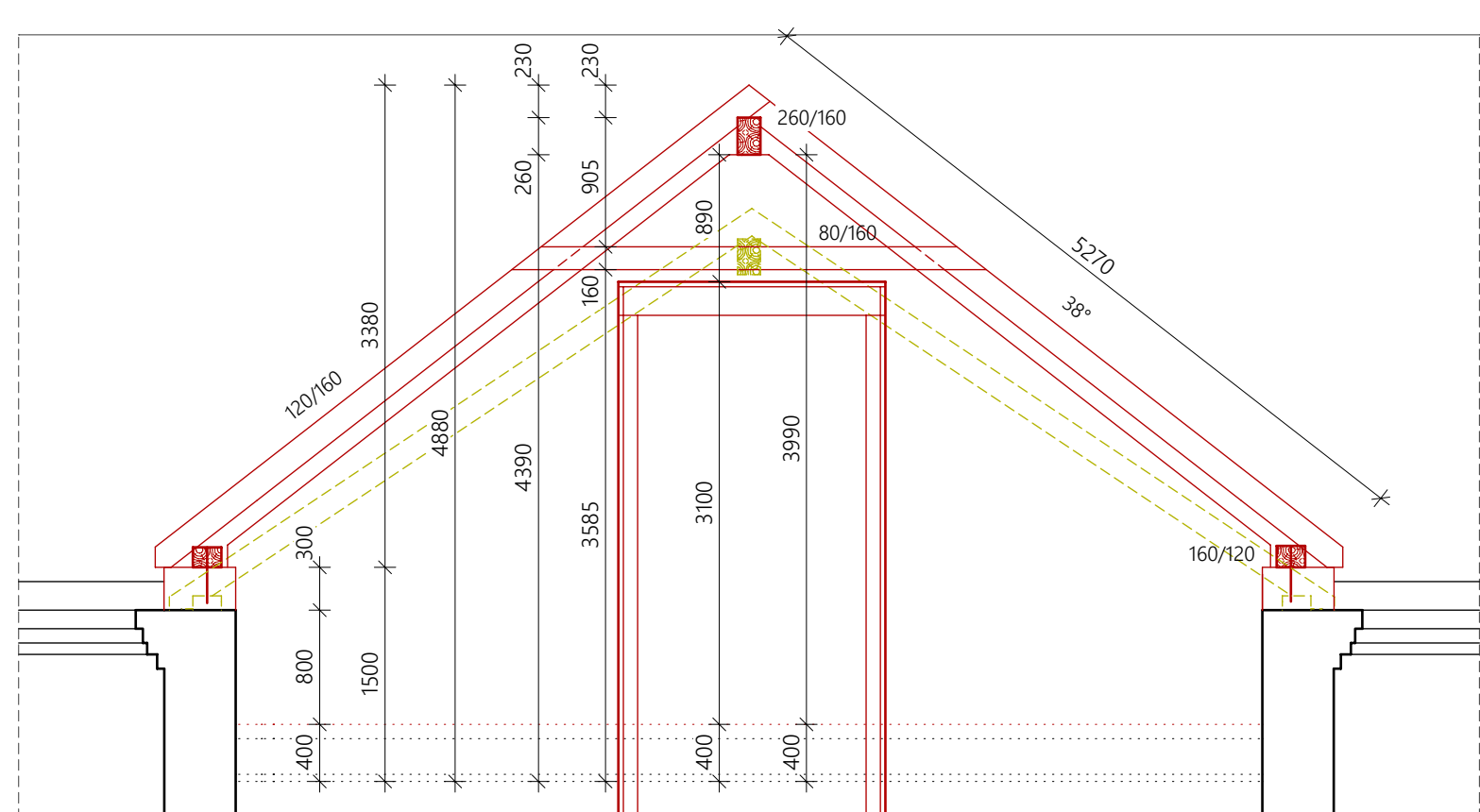
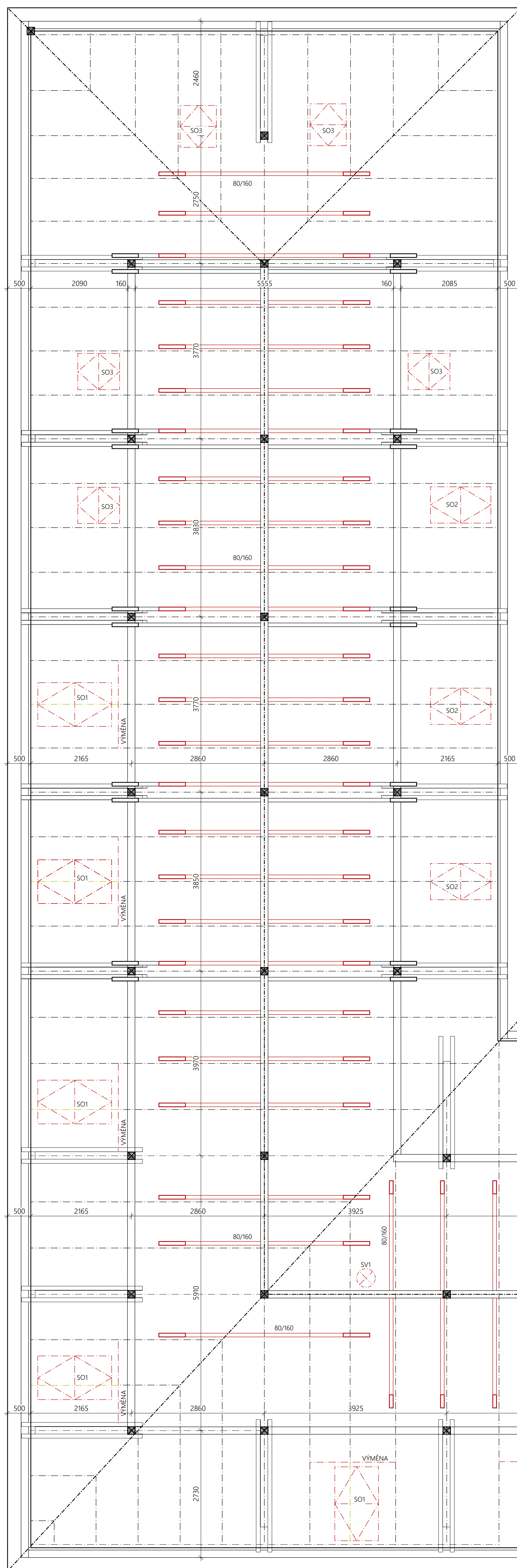
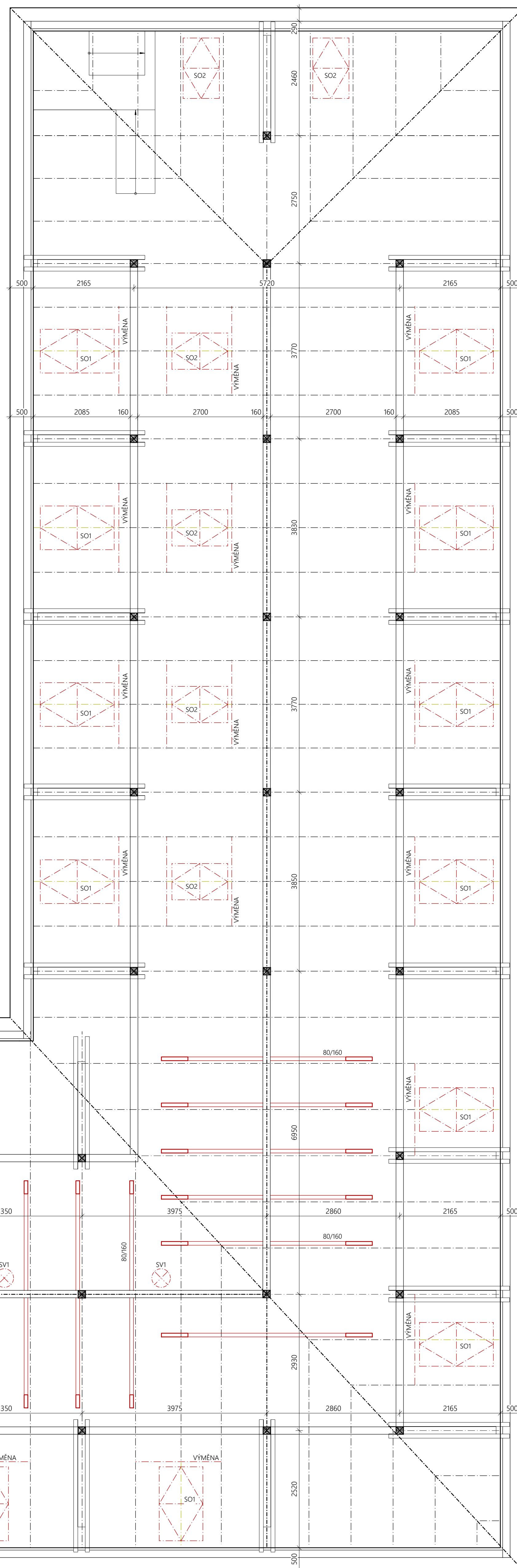

Technical drawing of a roof structure (Dachstuhl) showing a cross-section with dimensions. The drawing includes a gabled roof with a 20-degree slope. Key dimensions include a total width of 5050, a central span of 3365, and a side span of 300. A vertical height of 4070 is indicated. The drawing is labeled "Dachstuhl" and "1:20".